

1 Needleless drug preparation with a Luer Lock syringe

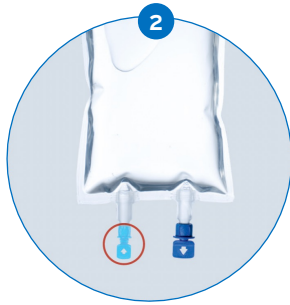

Check the solution composition, lot number and expiry date. Inspect the container for damage or leakage. **If damaged, don't use!**



Remove the overwrap. Identify the light blue injection port.



Break off the light blue tamper-evident cap from the **freeflex®+** additive port. **Membrane below the cap is sterile. Disinfection of the membrane is not necessary.**

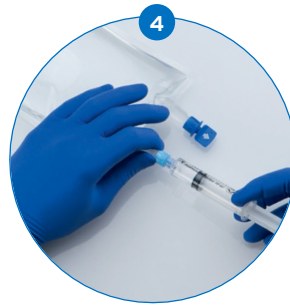

Connect the Luer Lock of the syringe with the additive port for needleless transfer of the drug from the syringe into the bag. **Do not use a needle for drug additions.**

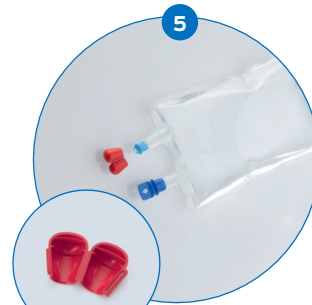

Remove the syringe and cover the injection port per your hospital policy.

2 Needleless drug preparation with a **freeflex+** Transfer Adapter



Remove vial cover. Disinfect top of vial* and let dry. Peel open **freeflex+** Transfer Adapter. Hold Transfer Adapter by exterior of the male Luer connector* to avoid engaging blue ring prematurely.



Insert the vial spike into a 20mm vial stopper without pushing blue ring downwards. Do not touch or contaminate Luer Lock or vial spike.



Once spike is inserted and vial is attached, **push the blue ring downward until you hear a "click" indicating it is secured to vial.**



Remove light blue protective cap from **freeflex+** IV bag injection port* and connect the Transfer Adapter by inserting the male Luer Lock to the IV bag injection port, then turning the Transfer Adapter clockwise. Ensure it is securely connected.



With IV bag above the vial, gently squeeze and release the bag multiple times until the vial is approximately half full of solution. Swirl the vial to ensure that medication is completely dissolved.



Invert the IV bag with the vial above the bag and gently squeeze and release the bag, pushing air into vial and drug into bag. Inspect the vial for any remaining drug. Repeat until vial is empty.



Remove Transfer Adapter and connected vial from injection port by twisting Adapter counter-clockwise. Swirl IV bag gently to ensure that drug is distributed evenly in IV fluid.

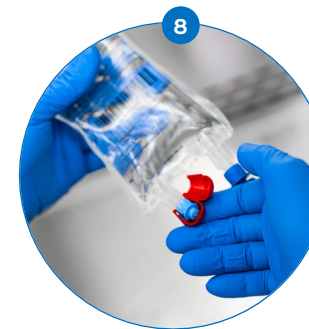

Cover injection port with a red protective cap.

Ensure that the drug is mixed completely with IV fluid. Failure to dilute and/or mix the drug may result in improper dosing to the patient.

* Per CDC recommendations or hospital protocol using aseptic technique.

- For single use only.
- Only use the **freeflex+** Transfer Adapter with **freeflex+** IV bag.
- Do not use if the package is opened or damaged.
- Please refer to the Instructions For Use for a complete list of safety and caution information for the **freeflex+** Transfer Adapter.

3 Infusion

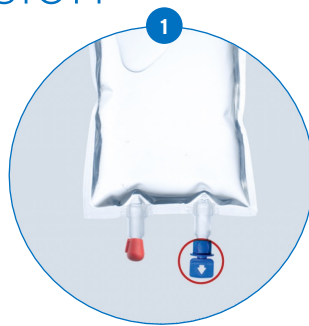

Identify the dark blue infusion port.



Break off the dark blue tamper-evident cap from the **freeflex+** infusion port. Membrane below the cap is sterile. Disinfection of the membrane is not necessary.

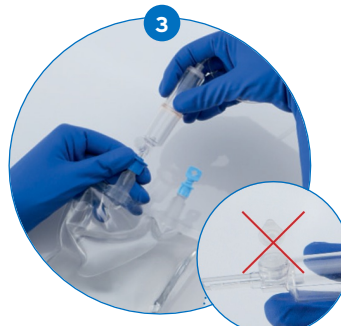

Use a non-vented infusion set or close the air-inlet on a vented set. Close the roller clamp of the infusion set. Hold the base of the dark blue infusion port. Insert spike through infusion port by rotating wrist slightly until the spike is set.



Hang the bag on the infusion stand.

Accessories



freeflex® Locking Protective Caps

The Power of Red - Fresenius Kabi bright red protective caps visibly indicate that medication has been added into the container and offers protection against tampering.



freeflex® Spiked Secondary Sets

These spiked secondary infusion sets feature a unique secure connection specifically for use with **freeflex** IV bags to help avoid spills. Color-coded spike and **freeflex** infusion port facilitate application management.

freeflex®+ with Luer Lock Port

